

Office to let

Globalworth Campus Building 1

Bucharest, Sector 2, 9 Dimitrie Pompeiu Blvd.

Building information

Building status	Existing
Year of construction	2010
Parking ratio	1 / 80 sq m
Total building area	29 000 sq m

Commercial terms

Office space*	after login *
Parking	after login *
Service charge*	after login *
Minimum lease term	after login *
Availability	after login *

* Asking terms for m²/month

Location

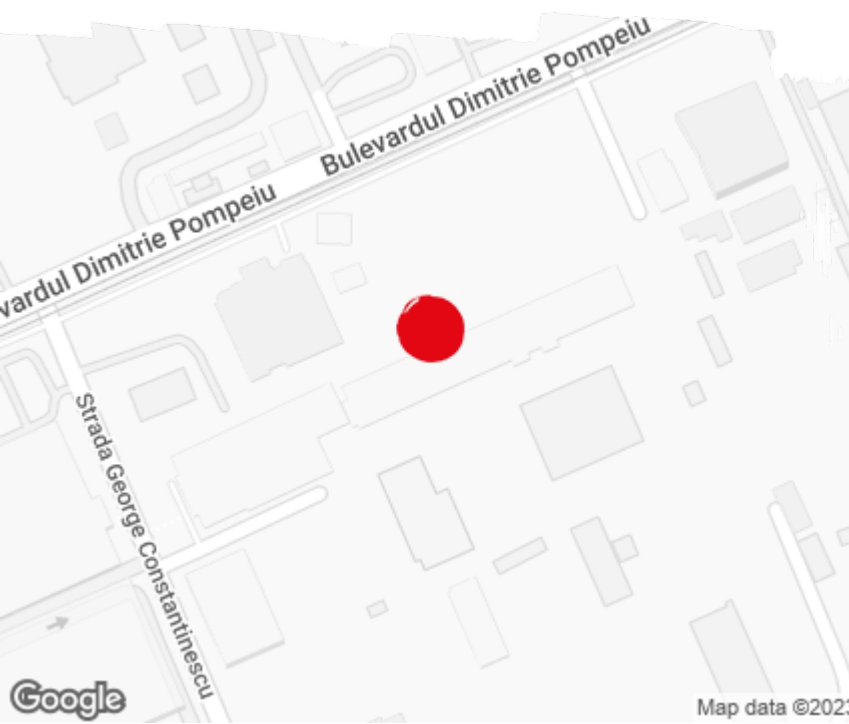

Available space

1 440 sq m

Available office space

500 sq m

Minimum office space

Typical floor plan

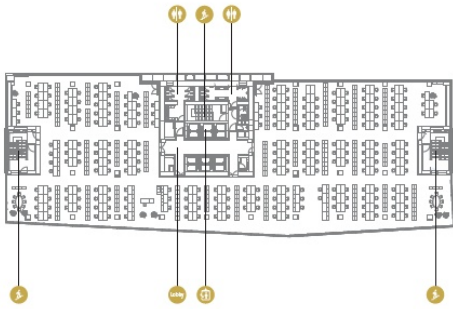

Available space

Floor	Vacant space	Availability
8	please contact us *	please contact us *
Total	after login *	

Public transport

Metro: M2
Bus: N125
Tram: 16, 36

Contact

 +40 21 302 3400

More information